

1/2 WE LIT (Completed)

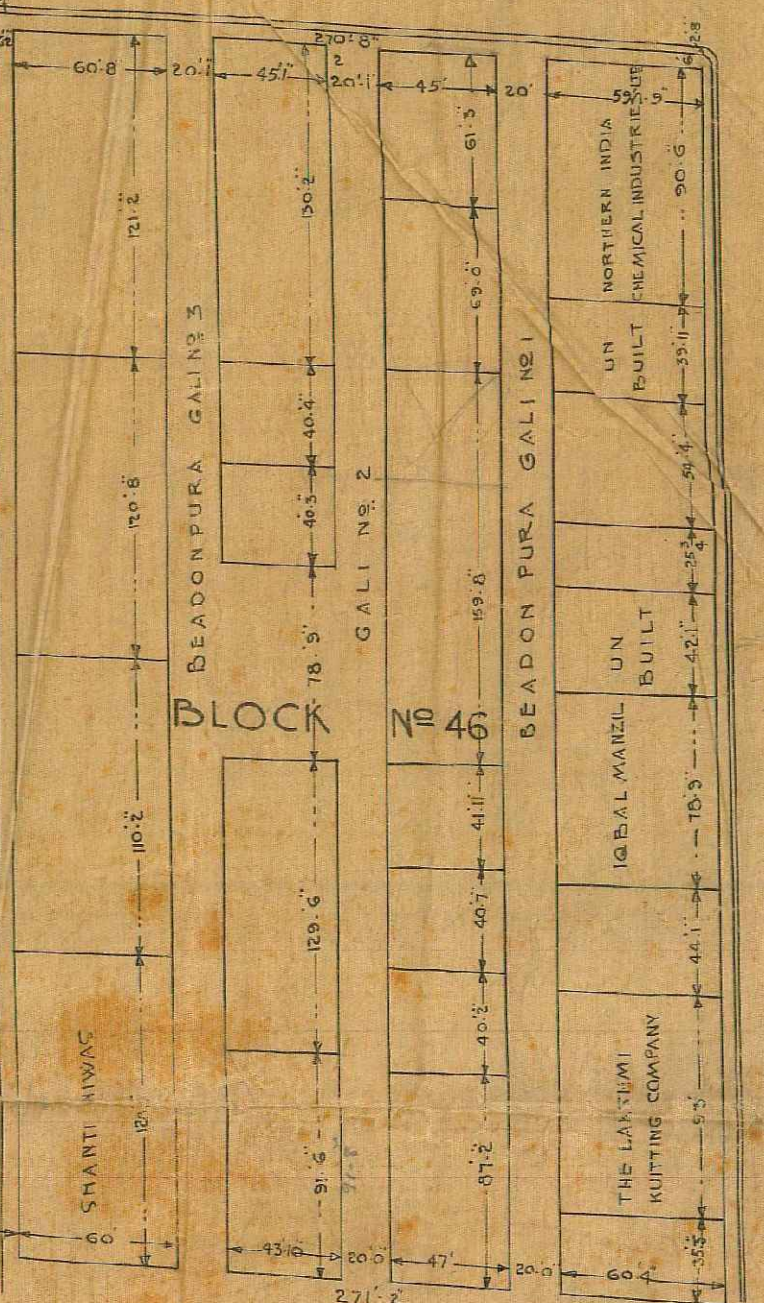
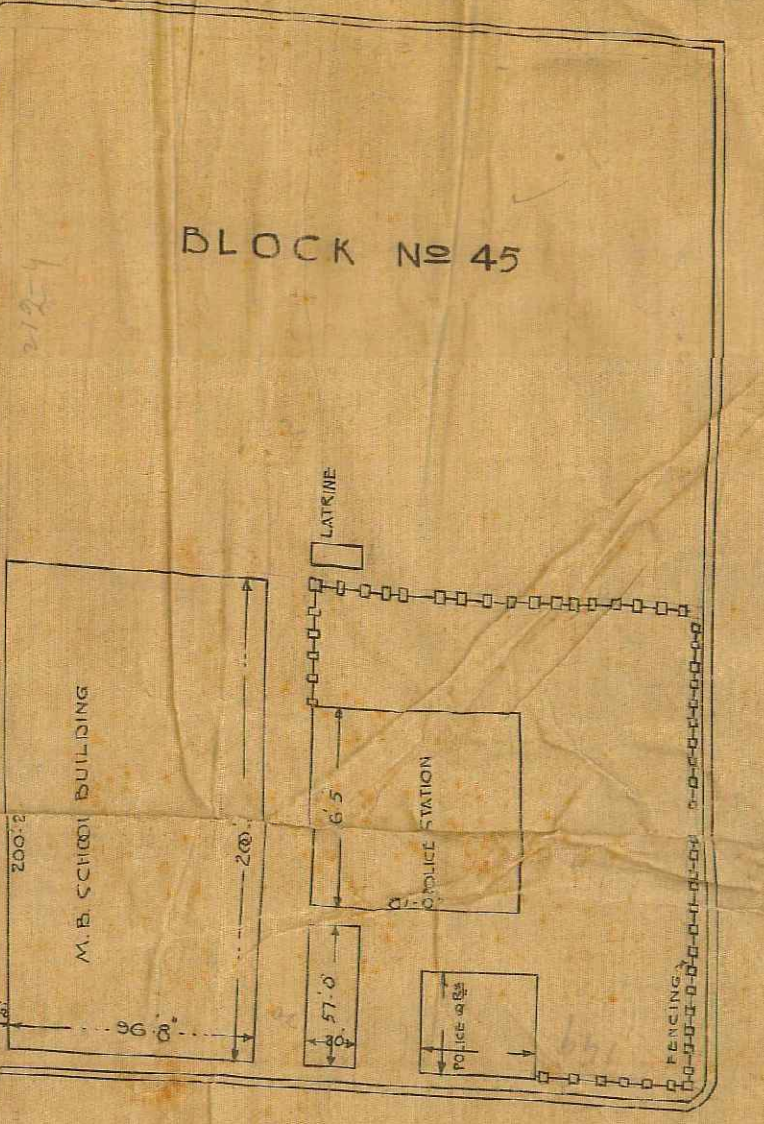
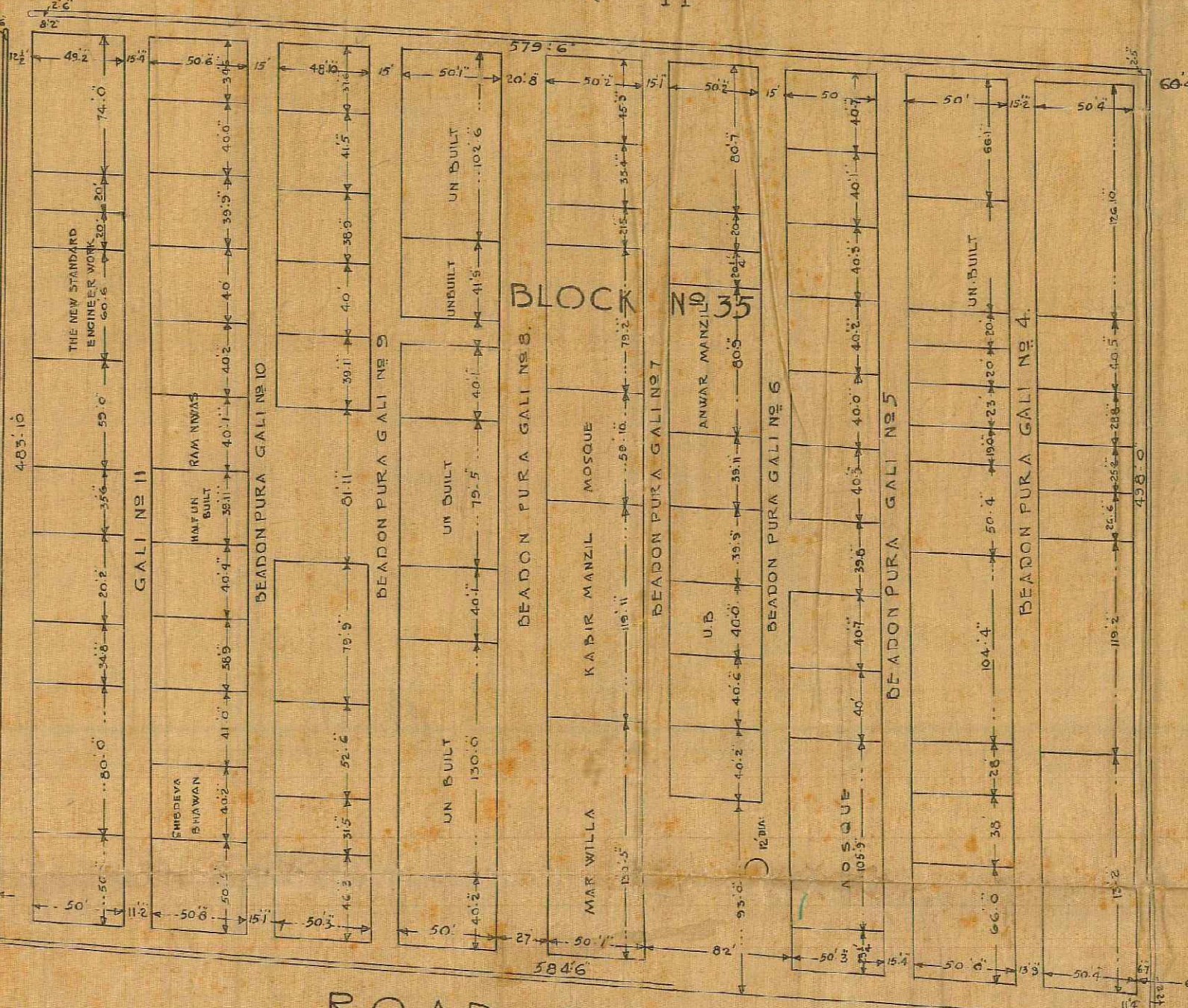
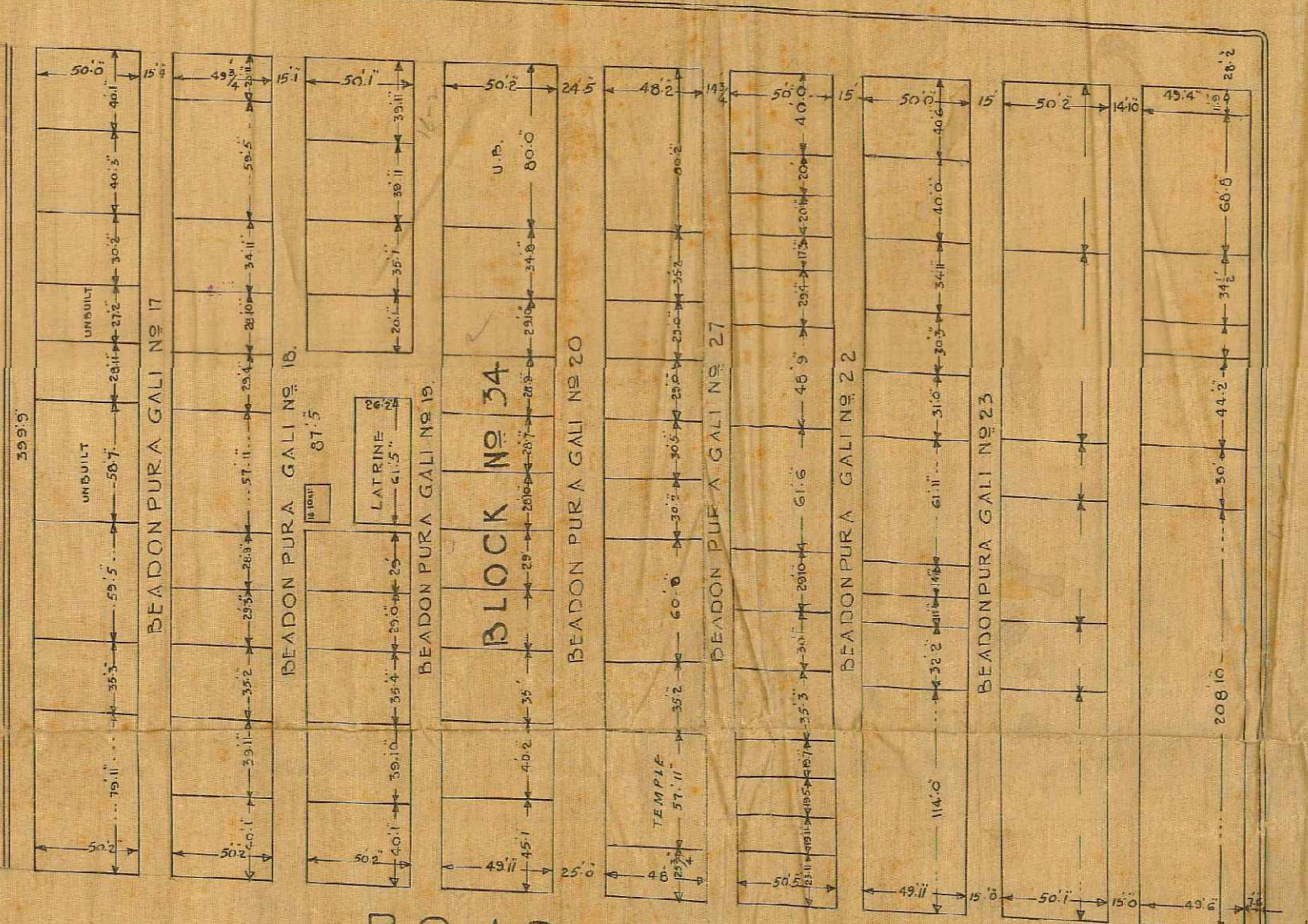
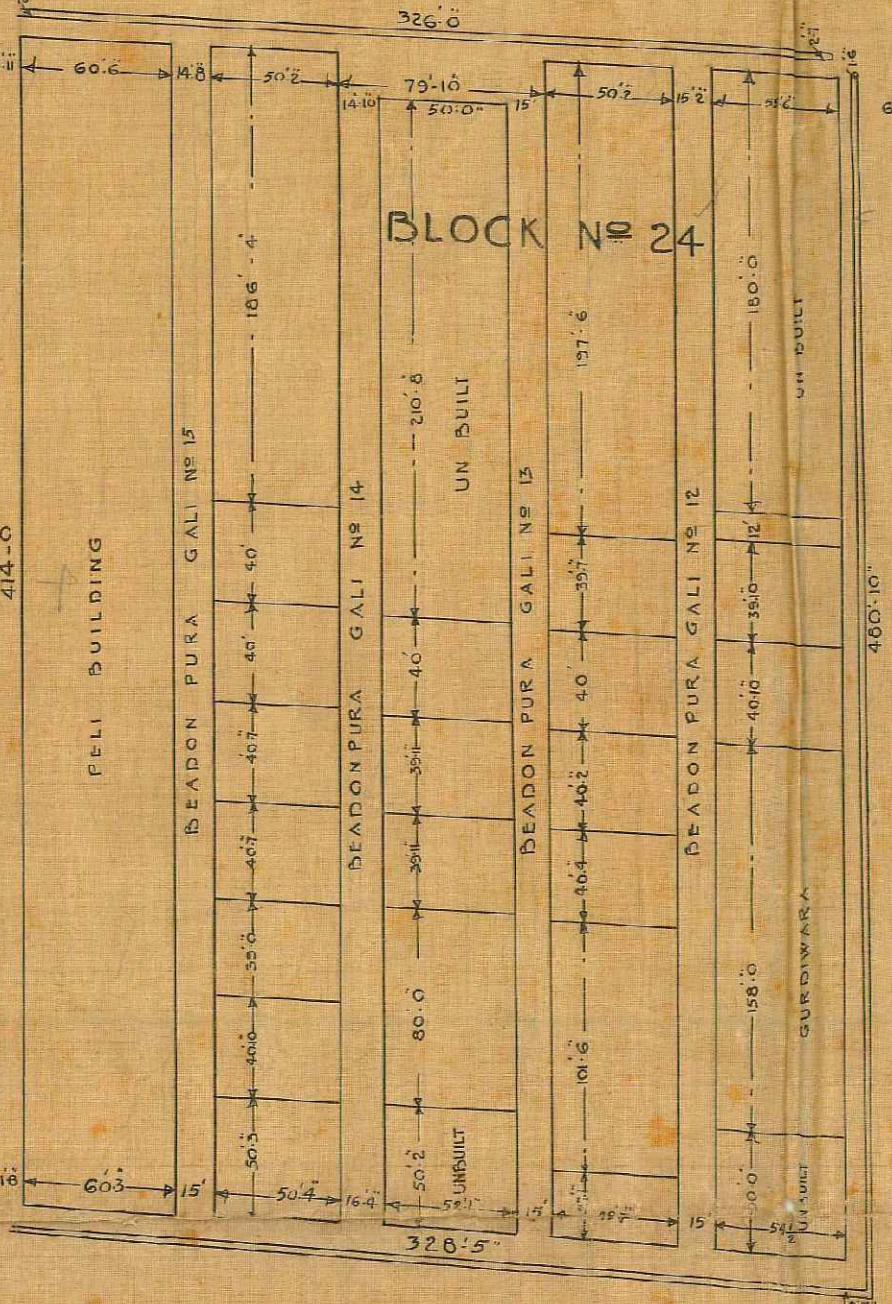
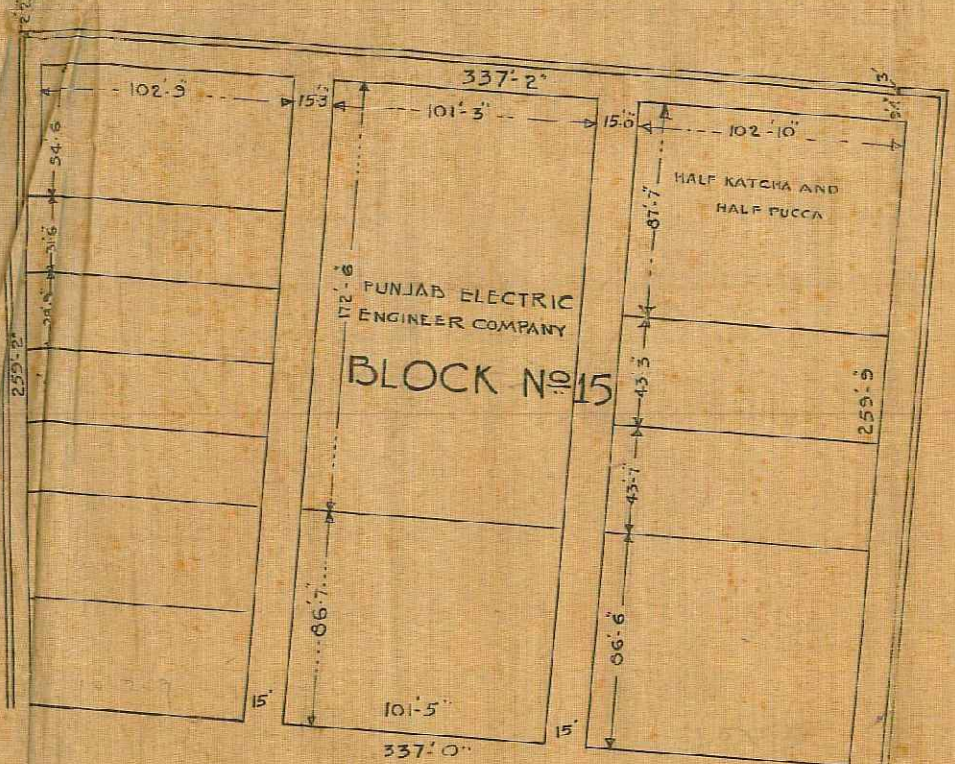
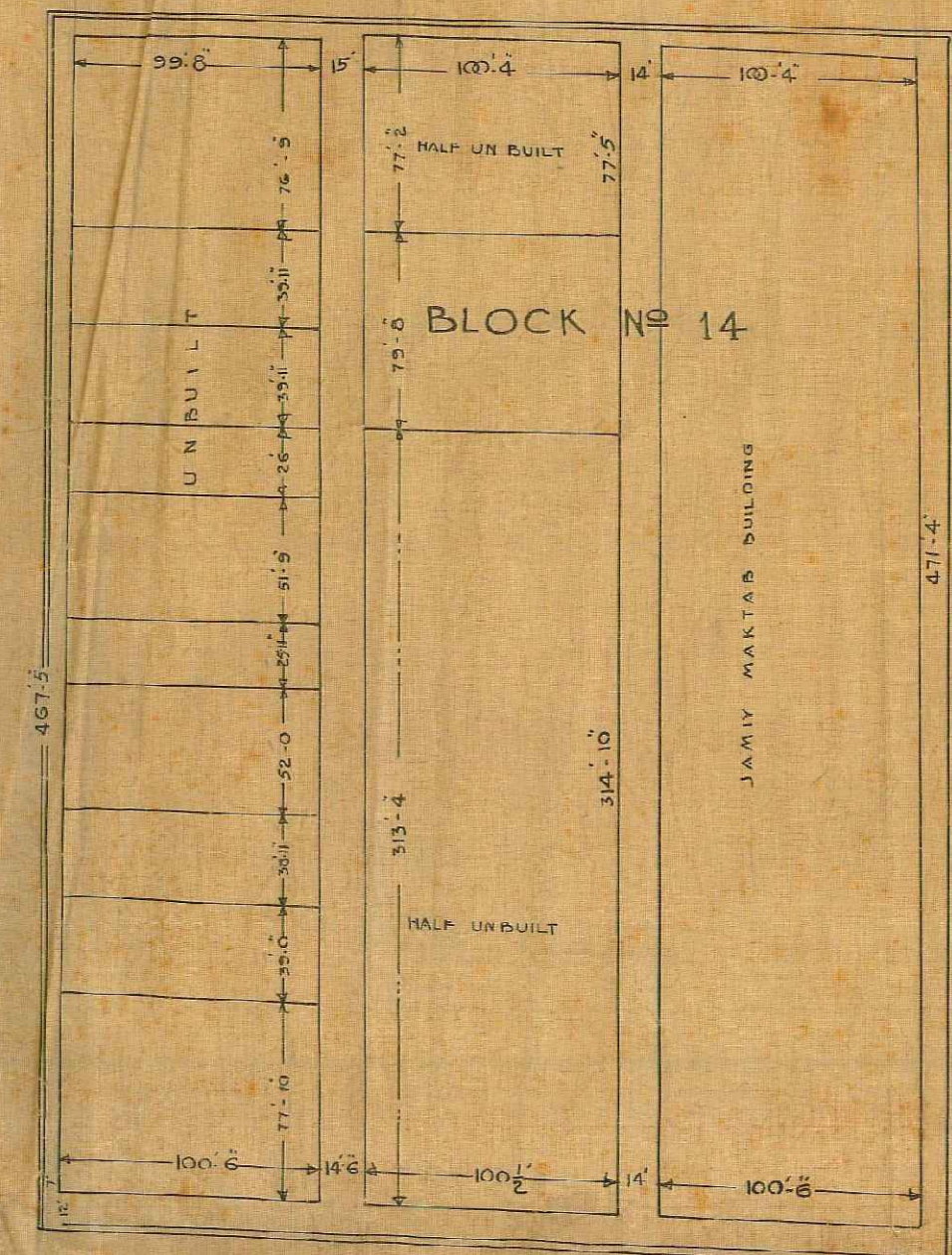

DELHI IMPROVEMENT TRUST
 WESTERN EXTENSION KARAU BAGH
 LAY OUT SHOWING BUILT OVER PORTION
 BLOCK NOS 14, 16, 23, 24, 34, 35, 45 & 46.
 SCALE 50 FEET TO AN INCH

76

A.R.I.B.A (CON)
 ARCHITECTURAL ASSISTANT
 DELHI IMPROVEMENT TRUST

I.T.A. No 78.

714

ORIGINAL ROAD 100' WIDE